

Table of Contents

Main features.....	2
Technical specifications of the Midland BTX2FM.....	2
Charging batteries.....	2
Unit and attaching system description.....	3
Switching your Midland BTX2FM on and off.....	4
Operative mode.....	4
Pairing two BTX2FM units.....	5
Compatibility with other Midland BT line units.....	5
Pairing more than two BTX2FM units.....	5
Talk 2 All - Pairing to a different brand intercom.....	6
Pairing the BTX2FM to Bluetooth devices.....	6
Pairing to a GPS Navigator.....	8
Listening to FM Radio.....	8
Using the wired audio input (AUX).....	9
Using a GMRS transceiver with the cable connection.....	9
Setup and special configurations.....	10
Setup and firmware update.....	11
Limited warranty.....	11
Accessories order form.....	12
Warranty Information.....	13

MIDLAND BTX2FM

Advanced Intercom System

The BTX2FM is an intercom communication system solution for motorcyclists. The design is slim and aerodynamic, and all main functions are easy to operate with three big buttons. The BTX2FM is fixed to the helmet using either the adhesive plate or the screw mounting clamp. With an audio kit and ultra slim speakers, you can enjoy high quality stereo music while riding.

Main features

- › Intercom driver to passenger up to 0.5 mile range
- › Connect up to 4 people for intercom communication (using Talk 2 All - Universal Intercom)
- › FM Radio with RDS
- › Connect your phone to receive or place phone calls and listen to music
- › Connect your GPS for voice street indication
- › Connection for GMRS radios with internal or external Bluetooth
- › AUX wired connection for MP3 players and GMRS radios
- › Setup and Firmware updates via USB connection to a PC

Midland BTX2FM is available in two versions:

- › Single BTX2FM Intercom kit with one unit only
- › Twin BTX2FM Intercom kit with two units

Depending on the model purchased, the package contains the following parts:

BTX2FM Single

- › 1 BTX2FM communication unit
- › 1 audio kit : Two stereo speakers with boom and wired microphones
- › 1 plate with bi-adhesive strip
- › 1 stereo audio cable for iPods or other MP3 players
- › 1 helmet clamp
- › 1 mini USB wall-mounting power supply

BTX2FM Twin

- › 2 BTX2FM communication units
- › 2 audio kits: Two stereo speakers with boom and wired microphones
- › 2 plates with bi-adhesive strip
- › 2 stereo audio cables for iPods or other MP3 players
- › 2 helmet clamps
- › 1 mini USB wall-mounting power supply with double plug

The units included in the TWIN kit are already paired and can therefore be immediately used in Intercom mode.

Technical specifications of Midland BTX2FM

General:

- › **Bluetooth ver. 3.0** stereo (Headset/Handsfree/A2DP protocol)
- › AGC system automatically controls the volume in relation to background noise
- › Voice (VOX) or manual communication activation
- › Manual controls to enable: telephone, intercom and wired connection
- › Fully waterproof
- › Lithium battery with up to 12 hours talk time
- › Recharge time is approximately 6 hours

Bluetooth connections:

With identical device for Driver-to-Passenger intercom or Bike-to-Bike intercom.

Bluetooth devices:

- › Cell phone with MP3 player Stereo (A2DP protocol), GPS (Garmin Zumo and TomTom Rider 1 and 2)
- › GMRS transceivers (with built-in or external Bluetooth connection) for group bike-to-bike communications

Wired connections:

- › Stereo audio input for iPod/MP3 player (with optional cable)
- › GMRS transceivers (with optional cable)

Attention: Midland BTX2FM is designed to withstand rain and water. Always verify that the rubber caps protecting the sockets are fully fitted.

Charging batteries

Attention: Make sure the unit is fully charged before use. Allow at least 8 hours for a full charge before using the unit for the first time.

Charge the unit by inserting the wall charger into the charging socket (lift the rubber cover to insert the plug).

The red LED on the unit will start flashing when charging begins.

Allow the headset to charge until the unit stops flashing or the blue LED turns on. When the charge is complete (the red LED is not flashing), release the headset from the charger.

After the initial charge it takes approximately 6 hours for a full charge.

Attention: Every time the mini USB recharging plug is inserted (or detached), the device is automatically turned off. To use while charging, you should turn the device on with the plug already inserted.

Unit and attaching system description

BTX2FM description

The BTX2FM has five buttons on the front; the three main big buttons are multi function buttons: "Forward" (on the left), "Middle" button and "Back" (on the right). The two small rounded buttons are the "Volume +" and "Volume -" buttons.

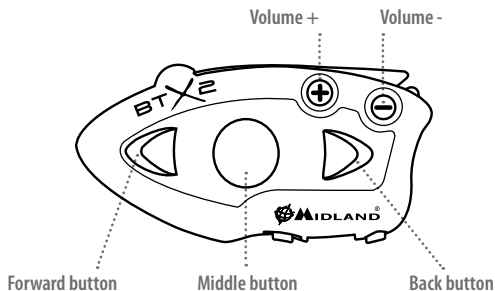

Description of the wired connections

On the bottom of the unit you can find three wired connections:

Charger jack: Recharges the unit using a standard mini USB power supply

Audio kit jack: Connects an audio kit (stereo headset and microphone)

Auxiliary audio jack (AUX) 2.5mm: Can be used to connect an audio source, like a stereo iPod/MP3 player or GMRS transceiver

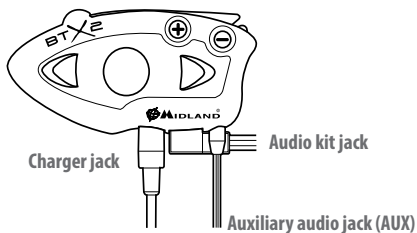

The BTX2FM has a flip up antenna on the top for maximum distance.

To lift the antenna, press gently backward and the antenna will automatically lift up.

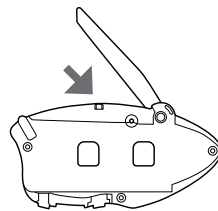

To close the antenna, press it down and be sure to move it back into the closed position.

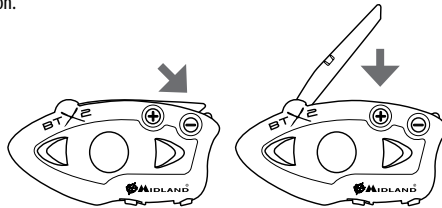

Description of the audio kit

The audio system includes two ultra-flat stereo speakers and two interchangeable microphones, both supplied with a bracket and wired connection.

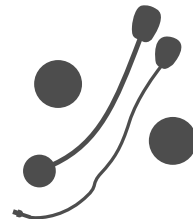

Attaching the stereo speakers

The two stereo speakers have a Velcro adhesive strip that aids in attaching them to your helmet.

Attention: Do not completely cover your ear with the speakers. You must always be able to listen to the sound of traffic.

The microphone can be attached to the helmet in the following 2 ways:

Boom microphone

Place the section with the Velcro adhesive strip between the padding and the rigid cover of the helmet so that the microphone is correctly positioned in front of your mouth and the white symbol is facing your mouth. This type of microphone is designed for Open Faced and Flip Front helmets.



Wired microphone

Using the Velcro adhesive strip, place the microphone inside the helmet in front of your mouth. This type of microphone is designed for Full Faced helmets. The mini connector on the microphone allows you to choose the microphone that best suits the helmet you are using.



Audio kit jack

The audio kit must be connected to the central jack of the Midland BTX2FM unit using the "L" shaped connector.

Description of the installation brackets

The Midland BTX2FM can be attached to the helmet in two different ways: The plate with bi-adhesive strip, or the clamp. These methods allow you to safely attach the BTX2FM unit onto your helmet and remove it at any time in order to recharge or store it.

Plate with bi-adhesive strip

The mounting plate has a bi-adhesive strip on one of its sides. To fix the plate in place, clean the application area on the helmet surface, remove the bi-adhesive film, and place the mounting plate on the helmet by keeping it in contact with the surface for a few seconds.



Screw Clamp

Using the Allen Key, loosen the two screws on the clamp and place the rear plate between the helmet padding and the external rigid protection. Then place the front plate outside and tighten the two screws in order to firmly fix the clamp in place. Inside the clamp is a small plastic spacer that can be removed for a tighter fit if required.

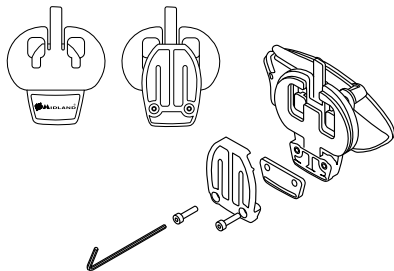

Attaching and removing your Midland BTX2FM

The BTX2FM is easily attached onto the helmet by sliding it down so it fits into the slot of the mounting device. The BTX2FM is held in position by the mounting clip located on the upper section.

To detach the BTX2FM, simply press the clip and push the unit up.

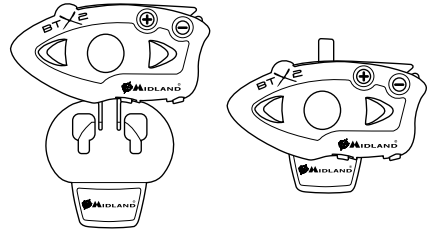

Switching your Midland BTX2FM on and off

Switching the unit on:

Press and hold the "Middle" button down for approximately 3 seconds until the Blue LED indicator comes on.

Switching the unit off:

Press and hold both the "Middle" and "Back" buttons together for approximately 3 seconds until the Red indicator flashes 3 times.

Operative mode

The BTX2FM can operate in three main "modes": Intercom, Phone and FM Radio. Each of the three multi-function buttons perform different actions depending on which mode the unit is on.

- > In "Intercom mode," the "Middle" button lets you manage communications between driver and passenger.
- > In "Phone mode," you can manage your Bluetooth phone and place or answer phone calls or listen to music (in stereo). Please use your phone responsibly and safely.
- > In "FM Radio mode," listen to your favorite radio station in stereo or seek for a specific radio station. Save it to one of the 6 memory slots available.

Switch from one mode to the next by holding the "Middle" button for 3 seconds. A voice announcement will state which mode you are in.

The toggle sequence is the following:

- > Intercom mode (if another unit has been paired)
- > FM Radio mode
- > Phone mode (if a phone has been paired)

Every time you turn on the unit, the default mode is Intercom (if it was previously paired to another unit), otherwise it will be Phone (if was paired to a phone).

If you need to know which mode the unit is in, press the “Volume +” and “Volume -” buttons together. A voice announcement will state the current mode.

Maximum Distance

You can reach .5 mile intercom distance if the flip up antenna is up and if you are in line of site without obstructions and interferences (the riders must always be in sight).

Pairing two BTX2FM units

If the model purchased is BTX2FM Twin then the the two units supplied in the same box are already paired and ready to use. The following procedure does not need to be performed.

If the devices were purchased individually, you need to first pair them in order to use them together.

Pairing the BTX2FM to another BTX2FM unit

First enter setup mode:

1. Turn off the unit.
2. Press and hold down the “Middle” button about 7 seconds until the Red LED light is on permanently.
3. Press the “Middle” button for 3 seconds. The Blue and Red LED lights will flash.
4. Do the same procedure on the other unit. When successfully paired, each unit will have the Blue LED light on for one second and then go back to setup mode (Red LED light always on).
5. Now that the pairing procedure is complete, you just need to exit setup mode before you can use the unit.
6. Double press the “Middle” button. The Red LED light will turn off and the Blue light will start flashing.

You can now use your BTX2FM.

How to use the Intercom

To use the intercom feature, be sure that both units are turned on and correctly paired together.

Manual activation

Press the “Middle” button on one of the two units. Communication is enabled, and remains active, until you press the “Middle” button again. The intercom takes a few seconds to activate. You will hear a beep tone when the intercom is open.

Voice activation (VOX)

Simply start talking. After several seconds the communication will be opened and will remain active for the time you are talking. If there is no conversation, the intercom will close after 40 seconds. If needed, you can close the intercom manually without waiting 40 seconds by pressing the “Middle” button.

Attention: The Voice activation (VOX) can open the intercom communication only to the unit that was paired with the “Middle” button. If you chose to use a different button, you will only be able to activate the intercom manually.

Disable the VOX feature by pressing the “Back” button for 7 seconds. A voice announcement will notify you when VOX is disabled. To turn VOX on again, press the same button and a voice announcement will advise you that VOX is now active. This setting is remembered if you turn off the unit.

Adjusting the volume

Your Midland BTX2FM uses AGC technology, which automatically adjusts the listening volume in relation to background noise.

You can also manually adjust the volume by pressing the “Volume +” and “Volume -” buttons.

Attention: Volume can be adjusted only when an audio connection is active.

Attention: The volume buttons cannot be used to adjust the volume of the wired audio source. The AGC system will automatically increase the volume when the motorcycle is at higher speeds.

Compatibility with other Midland BT units

The BTX2FM is compatible with the BT Next Conference and BTX1FM. When paired, the maximum range of the intercom is defined by the lowest unit.

The BTX2FM is compatible with the previous line of Midland BT line (BT Next, BTX2, and BTX1) only if updated to firmware version 2014 or greater. Download the latest version at midlandusa.com

Pairing more than two BTX2FM units

One BTX2FM unit can be paired to a maximum of three other BT units. That means 4 in total (3 Midland units + 1 Talk 2 All). You can use the “Middle” and the “Back” buttons to pair to a Midland unit and you can use the “Forward” button to pair the “Talk 2 All - Universal Intercom” feature.

The same button you use to pair the unit will also be used to open/close the intercom communication.

For example you can pair your passenger to the “Middle” button and another motorcyclist to the “Back” button.

First enter setup mode:

1. Turn off the unit.
2. Press and hold down the “Middle” button about 7 seconds until the Red LED light is on permanently.
3. Press the “Middle” or “Back” button for 3 seconds. The Blue and Red LED lights will flash.

- Do the same procedure on the other unit. When successfully paired, each unit will have the Blue LED light on for one second and then go back to setup mode (Red LED light always on).
- Now that the pairing procedure is complete, exit setup mode before you can use the units by double pressing the "Middle" button. The Red LED light will turn off and the Blue light will start flashing.

You can now use your BTX2FM.

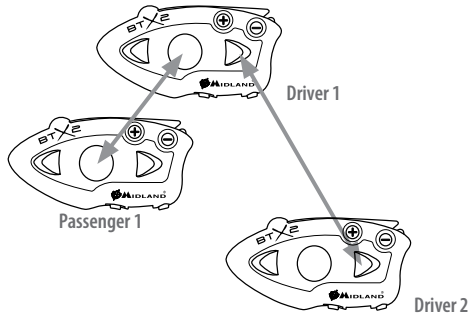

Unit already busy

If you try to open an intercom connection to another person who is already talking with someone else, you will hear a "busy" double beep tone. Wait a few seconds and try again.

The person who is called will be advised that someone is trying to call and will hear a voice announcement with the number of the button from which the request is coming.

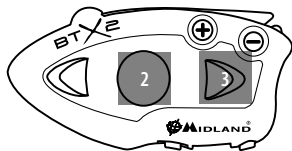

Talk 2 All - Pairing to a different brand intercom

Thanks to the "Talk 2 All - Universal Intercom" feature, it is now possible to pair your BTX2FM to a different brand intercom available on the market using the "Forward" button.

1. On the BTX2FM enter setup mode: With the unit OFF press and hold down the "Middle" button about 7 seconds until the Red LED light is on permanently.

2. Press the "Forward" button for 3 seconds. The Red and Blue LED light will flash.

3. On the other intercom (non-Midland brand) follow the procedure to pair to a phone.

When successfully paired, the Red and Blue LEDs will quit flashing.

To open the intercom communication on the BTX2FM, press the "Forward" button. On the other intercom press the phone redial button. It may be necessary to press the dial button twice, depending on the model of the other brand intercom.

Attention: When using this configuration, the other brand intercom cannot pair to a phone.

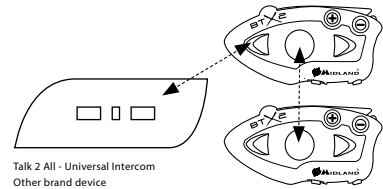

Pairing the BTX2FM to Bluetooth devices

The BTX2FM unit can be paired to other Bluetooth devices like phones, GPS navigators, or GMRS radios with built-in or external Bluetooth. The pairing procedure must be done using the "Volume +" button.

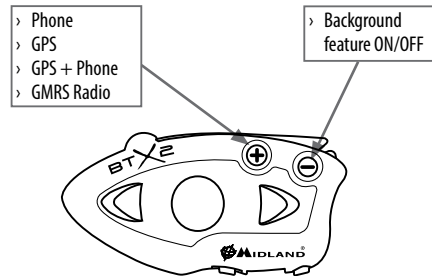

Support for Stereo (A2DP) voice announcement

The BTX2FM supports stereo (A2DP) voice announcement from GPS navigators or smartphone applications. When a voice announcement cuts in, the intercom or FM radio is interrupted to give priority to the announcement.

Bluetooth connection always in the Background

This feature lets you keep the Bluetooth connection on the “Volume +” button in the background even if the Intercom is open (for instance to keep the GPS navigator announcement in the background while the intercom is open).

Enabling/Disabling the Background feature:

Press the “Volume -” button for 3 seconds. A voice announcement will tell you the status. The background feature is active by default.

Attention: *Midland cannot guarantee this feature because it depends on a third party device.*

Pairing to a phone

The cell phone can only be paired to the “Volume +” button. When paired the “phone mode” is active. This way it is possible to manage all the phone functionalities and listen to the stereo music. An incoming call is the higher priority which means all other communications will be closed (Intercom, Music).

How to pair the BTX2FM to a Phone

First enter setup mode:

1. Turn off the unit.
2. Press and hold down the “Middle” button about 7 seconds until the Red LED light is on permanently.
3. Press the “Volume +” button for 3 seconds. The Blue and Red LED lights will flash.
4. Enable the Bluetooth device search feature on your phone
5. After a few seconds, “Midland BTX2FM” will be displayed on your phone. Follow the pairing procedure of your Phone. If a pin code is requested you should enter “0000” (four zeros).

When successfully paired, the Blue LED light of the BTX2FM will be on for one second and then the unit will exit setup mode and switch to the working mode (the Blue LED light will start flashing).

You can now use your BTX2FM together with the phone.

How to use a Phone with the BTX2FM

After pairing your phone to the BTX2FM you must switch to the “Phone” mode in order to use all the phone/MP3 music player’s features. If you are in “Intercom” mode you can only manage incoming phone calls. To activate the “Phone” mode, press the “Middle” button until you hear “Phone” from the voice announcement. Now all three main buttons are dedicated to the phone (see Table B).

Answering a call

When you hear the phone ring, you can answer in two different ways:

Vocally: Simply say one word to answer the call and start talking. You can only do this after the third ring.

Attention: *Be aware that some phones may not support voice answering.*

Manually: Tap the “Forward” button and start talking.

Rejecting a call in both Phone/Intercom mode

If you don’t want to answer, you can let the cell phone ring or press the “Forward” button for a few seconds (you will hear an audible confirmation tone).

Making a call in Phone mode only

There are several ways to make a call.

From the phone keypad:

Dial the number on the phone keypad:

Press “Send” on the phone.

To redial the last number:

Phone on “Volume +”: Press “Forward” button for 3 seconds in order to redial the last number (you will hear an audio confirmation tone).

Phone on “Volume -”: Press “Back” button for 3 seconds in order to redial the last number (you will hear an audio confirmation tone).

Table B-Phone mode

Mode	Forward button (Phone on “Volume +”)	Middle button	Back button (Phone on “Volume -”)
Phone	Tap: Voice dial /accept or close if it is in progress Long press (3 seconds): Redial last number/ or reject incoming call	Long press (3 seconds): Change mode	Tap: Voice dial /accept or close if it is in progress Long press (3 seconds): Redial last number/ or reject incoming call
Phone (when music is playing)	Tap: Next song	Tap: Play/pause Long press (3 seconds): Change mode	Tap: Previous song

To make a voice call:

Phone on “Volume +”: Tap the “Forward” button. If your phone supports voice calls, you will be asked to speak the name of the contact you wish to call.

Phone on “Volume -”: Tap the “Back” button. If your phone supports voice calls, you will be asked to speak the name of the contact you wish to call.

Priority: Calls have a high priority, which means that all other communications are temporarily disabled when a call arrives.

Ending a call in both Phone and Intercom mode

There are several ways to end a call:

- › Wait for the person you called to hang-up.
- › Press the “Forward” button (you will hear an audible confirmation tone).
- › Press the “End Call” button on the phone.

Using the MP3 player feature of the phone in Phone mode only

Many phones are now designed to be used as stereo MP3 players. The BTX2FM fully supports the A2DP and AVRCP protocols that enable you to listen to stereo music and remotely control your mobile phone’s MP3 player. You can even use the buttons on the BTX2FM to control the following play options: Play, Pause, Forward and Back.

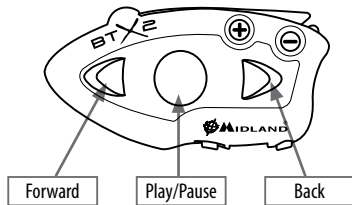

Available controls

- › To play/pause music: Press the “Middle” button.
- › To skip forward to the next song: Press the “Forward” button.
- › To skip back to the previous song: Press the “Back” button..

Priority: The music listening mode has the lowest priority. It will always be disabled when another type of communication is enabled.

Pairing to a GPS navigator

The GPS Navigator can be paired to the “Volume +” button. When paired the “phone mode” is active.

Attention: If you need to connect both a phone and GPS, you must pair the phone to the GPS itself.

Midland BTX2FM – Page 8

Pairing the BTX2FM to a GPS

First enter setup mode:

1. Turn off the unit.
2. Press and hold down the “Middle” button for 7 seconds until the Red LED light is on permanently.
3. For 3 seconds, press the “Volume +” button. The Blue and Red LED lights will flash.
4. Enable the Bluetooth device search feature on your GPS.
5. After a few seconds, “Midland BTX2FM” will be displayed on your GPS.
6. Follow the pairing procedure of your GPS. If a pin code is requested you must enter “0000” (four zeros).
7. When successfully paired, the Blue LED light of the unit will be on for one second and then the unit will exit setup mode and switch to the working mode (the Blue LED light will start flashing).

When you pair the GPS to the “Volume +” button, you lose the ability to pair a phone to the BTX2FM unit. You can overcome this limit by pairing the phone directly to the GPS and then the GPS to the BTX2FM unit. All phone features are then managed by the GPS unit.

GPS navigator always in the background

To keep the intercom open while the GPS gives turn by turn directions you must have the “background” feature active.

Attention: Midland cannot guarantee this feature because it depends on a third party device.

Listening to FM Radio

The FM Radio receiver is integrated. Switch to the “FM Radio” mode in order to use it. Long press (3 seconds) the “Middle” button until you hear “FM Radio” from the voice announcement. Now all three main buttons are dedicated to the FM Radio (See Table C).

Tap the “Forward” or “Back” button to seek the FM Radio station. When you long press (3 seconds) the “Forward” or the “Back” button, you can scan up or down between 6 recorded stations. A voice announcement will tell you the memory slot number you are entering. A double beep tone will sound when the first or last recorded station is reached.

To save the station you are listening to, press the “Forward” and “Back” buttons together for 3 seconds. You will hear a beep tone for confirmation.

The station is saved over the last recorded station used.

Using the RDS system, the BTX2FM will stop on the strongest signals available. RDS is a standard for embedding digital information in FM Radio broadcasts. The RDS system is OFF by default. If needed, you can toggle the RDS on/off by pressing the “Volume +” and “Volume -” buttons together for 3 seconds when the radio is on. A voice announcement will tell you the RDS status.

FM Radio with intercom

When you are in “FM Radio” mode you can only open the intercom using the VOX feature to the unit paired on the “Middle” button. To manually activate the intercom you must switch to “Intercom” mode.

Disabling/Enabling the FM Radio

To disable the FM Radio press the “Forward” button for 7 seconds. Your selection will be confirmed by the “FM Radio disable” voice announcement. To enable the FM Radio press the “Forward” button again for 7 seconds. Your selection will be confirmed by the “FM Radio” voice announcement.

Pairing to a GMRS radio with integrated Bluetooth

If your GMRS transceiver has integrated Bluetooth, pair the transceiver using the “Volume +” button:

- › Turn off the unit.
- › Press and hold down the “Middle” about 7 seconds, until the Red LED light is on permanently.
- › Press the “Volume +” button for 3 seconds. The Blue and Red LED lights will flash.
- › Follow the pairing procedure explained in the manual of the transceiver.

Attention: The GMRS audio connection can be set to “Stand by” simply by pushing the “Forward” button on the BTX2FM in “Phone” mode.

Attention: The “Background” feature must be active if you want to keep the two way radio communication connected with the intercom.

Using the wired audio input

Your Midland BTX2FM is also supplied with a wired audio input (AUX) that can be used to connect an audio source like an iPod (or any other MP3 Player) or a GMRS transceiver for group communication or to increase range.

Listening to music

To listen to music from the wired input (AUX), connect the audio source using the optional AUX cable. The volume buttons cannot be used to adjust the volume of the wired audio source. The AGC system will automatically increase the volume when the motorcycle is at high speeds.

Attention: Never set the volume of the MP3 player to the maximum possible.

Hint: We recommend performing a few tests adjusting the volume of your iPod/MP3 player so at normal speed the headset volume is suited to your needs. The AGC system will automatically increase the volume at higher speeds. Make a note to remember this setting for future trips.

Enabling/disabling the wired input

If needed, the wired input (AUX) can be enabled or disabled:

Long press (3 seconds) the “Back” button. You will hear one beep to enable wired input and two beeps to disable.

Using a GMRS transceiver with the AUX connection

In order to connect the transceiver to your Midland BTX2FM, you must purchase the specific 2.5mm plug AUX cable, sold separately.

Some manufacturer radios use a different pin configuration, so ask your dealer which cable is best suited to your needs.

The cable connected to the transceiver normally also has a PTT button that can be placed on the handlebar of your bike or held in your hand (if you are the passenger). To communicate via the attached radio, press the PTT button to speak and release it to listen. It is not possible to talk and listen simultaneously.

Adjust the volume of the transceiver to your needs, remembering that the volume adjustment is controlled by the AGC system and that it will be automatically increased in relation to background noise.

If using a GMRS transceiver for group communications and simultaneously maintaining the Intercom feature enabled between two or more BTX2FM devices, every time you talk to communicate with the GMRS transceiver (pressing the PTT button), you will also activate the intercom of the BTX2FM to the unit connected to the “Middle” button (thanks to the VOX feature).

To avoid Intercom activation when you speak on the GMRS transceiver, you can pair the BTX2FM unit on the “Back” or “Forward” button (where VOX is not active) or if you still want to use the “Middle” button, disable the VOX feature as explained on page 10.

Attention: If you disable the VOX feature, you will only be able to answer incoming phone calls by pressing the “Forward” button.

Table C - FM Radio mode

Mode	Forward button	Middle button	Back button
FM Radio	Tap: Seek station up Long press (3 seconds): Station recorded	Tap: On/off Long press (3 seconds): Change mode	Tap: Seek station down Long press (3 seconds): Station recorded

Setup and special configurations

Resetting all paired devices

You may find it necessary to delete all the pairing references stored in the BTX2FM unit (reset operation).

First enter setup mode:

- › Turn off the unit.
- › Press and hold down the “Middle” button for approximately 7 seconds until the Red LED light is on permanently.
- › Simultaneously press and hold down the “Volume +” and “Volume -” buttons for 3 seconds. The Blue LED Light will turn on for 1 second and then go back to steady Red.
- › Double press the “Middle” button to exit setup mode.

This procedure deletes all the paired Bluetooth devices stored in the memory to start a new “clean” pairing session.

Back to factory setting

Sometimes it may be necessary to go back to the factory settings. This resets all the options and changes already made and makes it a “clean” unit.

First enter setup mode:

- › Turn off the unit.
- › Press and hold down the “Middle” button for approximately 7 seconds until the Red LED light is on permanently.
- › Simultaneously press and hold down all three buttons “Forward,” “Middle,” and “Back” for 3 seconds. The Blue LED Light will turn on for 1 second and then go back to steady Red.
- › Double press the “Middle” button to exit setup mode and use the BTX2FM.

Adjusting/disabling the VOX feature (Intercom and telephone)

The Intercom feature can be enabled both manually and vocally (VOX). Vox activation is influenced by the helmet type and background noise.

To adjust VOX for optimum results, choose one of the following four microphone sensitivity levels: high, medium, low, or very low. The default setting of the BTX2FM is low. It is also possible to disable the VOX feature in order to activate the Intercom and phone call answering features in manual mode only.

Adjusting the sensitivity of the microphone (VOX)

First enter setup mode:

1. Turn off the unit.
2. Press and hold down the “Middle” button about 7 seconds until the Red LED light is on permanently.
3. Your BTX2FM is now in setup mode.
4. Tap the “Back” button and the Red LED light changes to a steady Blue.

5. Press “Volume +” or “Volume -” to adjust sensitivity. Every time you press the Volume buttons the Red LED light will flash for confirmation. When you reach the end of the upper and lower limit, the Red light will not flash.
6. Tap the “Back” button; the Blue LED light will flash several times to display the selected sensitivity:
 - One flash = VOX disabled
 - Twice = Very low sensitivity
 - 3 times = Low sensitivity
 - 4 times = Medium sensitivity (default setting)
 - 5 times = High sensitivityThe LED light indicator now remains steady Red (setup mode) and the changes are confirmed.
7. You can adjust the sensitivity again by repeating the steps from step 1, otherwise, exit setup mode by double pressing the “Middle” button. Once the Red LED light turns off, the Blue LED will start blinking.

Disabling the VOX feature (Intercom and telephone)

Follow all procedures described in the previous steps and choose the option of only one flash (VOX disabled).

Wired connection always in the background

This feature lets you keep the wired connection on, even when the phone or the intercom is open. This feature can be useful when you connect a GMRS transceiver. By default this option is on.

Disabling:

- › Enter setup mode.
- › Turn off the unit.
- › Press and hold down the “Middle” button for 7 seconds until the Red LED light is on permanently.
- › Press the “Forward” and “Middle” button together for 3 seconds. The Blue LED will flash three times.
- › Double press the “Middle” button to exit setup mode and use the BTX2FM.

Enabling:

Follow the same procedure described above; now the Blue LED will flash once. To exit setup mode, double press the “Middle” button.

Setup and firmware updates

It is possible to configure and update the firmware of your BTX2FM using the USB connection to your PC. On the Midland website, www.midlandusa.com, on the BTX2FM page you can find the PC software and new firmware updates if available.

ATTENTION: DO NOT CONNECT THE UNIT TO THE PC BEFORE YOU DOWNLOAD AND INSTALL THE SOFTWARE!

Use at your own risk

The use of this device can impair your ability to hear other sounds and others around you.

Listening to music or speaking on a telephone may prevent you from hearing others around you and distract you from riding safely. The use of such device while riding may endanger you and others, and its use, in some areas, could be prohibited.

Using this device at a high volume may result in permanent hearing loss.

If you experience ringing in your ear or any other hearing related pain, reduce the volume or discontinue using this device. With continued use at high volume, your ears may become accustomed to the sound level, which may result in permanent damage to your hearing.

Please use this device at a safe volume level.



2-Way Radios



Weather Radios

 **Bluetooth®**



Bluetooth Headsets



HD Wearable Video Cameras



Marine Radios



Emergency Crank Radios



CB Radios

Check out these and other great products at
midlandusa.com

Accessories Order Form

Please send Money Order or fill in the Visa/Master Card information and mail to the address below.

Please DO NOT send cash or checks. Make Money Order to Midland Radio Corporation.

Name: _____

Address: _____

City: _____ State: _____ Zip Code: _____

Telephone: _____ E-mail: _____

Credit Card# _____ Type: _____ Exp: _____

QTY	ITEM	DESCRIPTION	PRICE	TOTAL
	BTA102	Mounting Kit	\$29.99	
	BTA301	Stereo Auxiliary Cable	\$9.99	
	BTA302	Bluetooth GMRS Cable	\$39.99	
	BTH103	Bluetooth Hi-Fi Speakers	\$39.99	
	BTREMOTE	Bluetooth Remote Control	\$99.00	
	XTA110	Mini USB Charge Cable	\$10.00	
	XTA111	USB DC Adapter	\$19.99	
	XTA112	USB AC Adapter	\$19.99	

Mail To: Midland Radio Corporation Consumer Dept. 5900 Parretta Drive Kansas City, MO 64120 <hr style="width: 20%; margin-left: 0;"/> Or Call 816.241.8500	<table style="width: 100%; border-collapse: collapse;"> <tr> <td style="width: 30%;">Sub-total</td> <td style="width: 70%; text-align: right;">_____</td> </tr> <tr> <td>Tax (MO, FL, WA Only)</td> <td style="text-align: right;">_____</td> </tr> <tr> <td>S&H</td> <td style="text-align: right;">\$ _____ 14.95</td> </tr> <tr> <td colspan="2">(Applies to Domestic US only. For Hawaii, Alaska, and Puerto Rico S&H will be \$38.25 for 1 lb. and \$64.25 for 2 lb. or more).</td> </tr> <tr> <td>Total</td> <td style="text-align: right;">\$ _____</td> </tr> </table>	Sub-total	_____	Tax (MO, FL, WA Only)	_____	S&H	\$ _____ 14.95	(Applies to Domestic US only. For Hawaii, Alaska, and Puerto Rico S&H will be \$38.25 for 1 lb. and \$64.25 for 2 lb. or more).		Total	\$ _____
Sub-total	_____										
Tax (MO, FL, WA Only)	_____										
S&H	\$ _____ 14.95										
(Applies to Domestic US only. For Hawaii, Alaska, and Puerto Rico S&H will be \$38.25 for 1 lb. and \$64.25 for 2 lb. or more).											
Total	\$ _____										

To order online go to midlandusa.com

LIMITED WARRANTY (United States and Canada)

Subject to the exclusions set forth below, Midland Radio Corporation will repair or replace, at its option without charge, any Midland Bluetooth Intercom which fails due to a defect in material or workmanship within Two Years following the initial consumer purchase.

This warranty does not apply to water damage, battery leak, abuse or misuse of unauthorized accessories, unauthorized service or modification or altered products. Accessories have a 90 day warranty from date of purchase, including any chargers, mounts, and cables.

This warranty does not include the cost of labor for removal or re-installation of the product in a vehicle or other mounting.

ANY IMPLIED WARRANTIES, INCLUDING, WITHOUT LIMITATION THE IMPLIED WARRANTIES OF MERCHANTABILITY AND FITNESS FOR A PARTICULAR PURPOSE, SHALL BE LIMITED AS SET FORTH HEREIN AND TO THE DURATION OF THE LIMITED WARRANTY, OTHERWISE THE REPAIR OR REPLACEMENT AS PROVIDED UNDER THIS EXPRESS LIMITED WARRANTY IS THE EXCLUSIVE REMEDY OF THE CONSUMER AND IS PROVIDED IN LIEU OF ALL OTHER WARRANTIES, EXPRESS OR IMPLIED. IN NO EVENT SHALL MIDLAND BE LIABLE, WHETHER IN CONTRACT OR TORT (INCLUDING BUT NOT LIMITED TO NEGLIGENCE, GROSS NEGLIGENCE, BODILY INJURY, PROPERTY DAMAGE AND DEATH) FOR DAMAGES IN EXCESS OF THE PURCHASE PRICE OF THE PRODUCT OR ACCESSORY, OR FOR ANY INDIRECT, INCIDENTAL, SPECIAL OR CONSEQUENTIAL DAMAGES OF ANY KIND, OR LOSS OF REVENUE OR PROFITS, LOSS OF BUSINESS, LOSS OF INFORMATION OR DATA OR OTHER FINANCIAL LOSS ARISING OUT OF OR IN CONNECTION WITH THE ABILITY OR INABILITY TO USE THE PRODUCTS OR ACCESSORIES TO THE FULL EXTENT THESE DAMAGES MAY BE DISCLAIMED BY LAW.

For Product Purchased in the USA:

Performance of any obligation under this warranty may be obtained by returning the warranted product, prepaid freight, along with proof of purchase to:

Midland Radio Corporation
Warranty Service Department
5900 Parretta Drive
Kansas City, MO 64120

This warranty gives you specific legal rights, and you may also have other rights, which vary from state to state.

Note: The above warranty applies only to merchandise purchased in the United States of America or any of the territories or possessions thereof, or from a U.S. Military exchange.

Midland BTX2FM – Page 13

For Product Purchased in Canada:

Performance of any obligation under this warranty may be obtained by returning the warranted product, along with proof of purchase, to your place of purchase in Canada.

This warranty gives you specified legal rights. Additional warranty rights may be provided by law in some within Canada.

FCC Compliance Information

This device complies with Part 15 of the FCC Rules. Operation is subject to the following two conditions: (1) this device may not cause harmful interference, and (2) this device must accept any interference received, including interference that may cause undesired operation.

You are cautioned that changes or modifications not expressly approved by the part responsible for compliance could void the user's authority to operate the equipment.

"This device complies with Industry Canada licence-exempt RSS standard(s). Operation is subject to the following two conditions: (1) this device may not cause interference, and (2) this device must accept any interference, including interference that may cause undesired operation of the device."

"This equipment complies with Industry Canada radiation exposure limits set forth for an uncontrolled environment."

NOTE: This equipment has been tested and found to comply with the limits for a Class B digital device, pursuant to part 15 of the FCC Rules. These limits are designed to provide reasonable protection against harmful interference in a residential installation. This equipment generates, uses and can radiate radio frequency energy and, if not installed and used in accordance with the instructions, may cause harmful interference to radio communications. However, there is no guarantee that interference will not occur in a particular installation. If this equipment does cause harmful interference to radio or television reception, which can be determined by turning the equipment off and on, the user is encouraged to try to correct the interference by one or more of the following measures:

- » Reorient or relocate the receiving antenna.
- » Increase the separation between the equipment and receiver.
- » Connect the equipment into an outlet on a circuit different from that to which the receiver is connected.
- » Consult the dealer or an experienced radio/TV technician for help.