



# UNIDEN

## R9w

### QUICK START GUIDE

This Quick Start Guide provides basic information on setting up the R9w. Refer to the R9w Owner's Manual for details. This manual is located on the USB drive included in the packaging.

#### ABOUT R9w

R9w is an advanced professionally-installed laser radar detector with laser interruption capabilities. Front and rear radar detectors and laser transponders provide outstanding detecting range while its sleek design blends with your vehicle's interior. An alert LED lets you know if signals are coming from the front (red) or rear (blue). If no signals are detected, the LED is green. If LED Initial Setting is ON, the LED is green if no signals are received. If LED Initial Setting is OFF, then the LED is also off if no signals are detected.

This illustration shows R9w's basic element placement (your installer will place these elements according to your vehicle's specific layout).

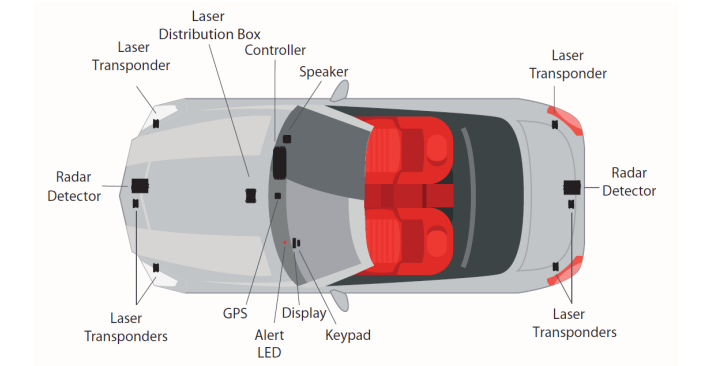

#### R9w SETUP

After professional installers have set up your R9w system's hardware, it's time to configure the firmware through the Menu system. Use the R9w keypad and display to access the Menu system.

#### KEYPAD

The keypad provides menu selection as well as adjusts the volume, alarms, user marks, and backlight.



KEY	PURPOSE
MUTE/DIM	Mutes Radar and Laser alarms under certain conditions. Controls backlight brightness.
PWR	Press to turn the R9w on; press and hold to turn the R9w off. With the <b>PWR</b> button, users can set the Laser Transponder setting as follows: Press the <b>PWR</b> button to disable Laser Transponder (Receive Mode) while R9w is operating. Press the button again to return to the user settings (Constant Mode/Pulse Mode/Receive Mode).
MARK	Sets specific locations to be recognized in the future.
VOL + / VOL -	Raises and lowers volume. Scrolls through menus.
MENU	Scrolls through sub-menus.

#### DISPLAY UNIT

The separate display unit works in conjunction with the keypad and is the visual display for alarms, alerts, menu selections, etc. It also displays signal frequency, signal strength, and from which direction the signals are coming.



#### ACCESSING MENU SYSTEM

Press the **MENU** key on the keypad to show the menu on the display. Press again to view options within that menu item. Press **VOL +** or **VOL -** to move to the next (or previous) menu item.

This graphic shows the menu path to set *Mode*, the first menu item.

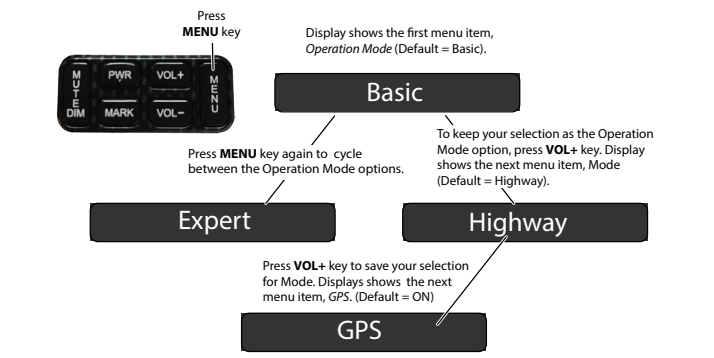

#### R9w MENU SETUP

There are 3 main areas you'll want to set up:

- R9w basics (turn GPS on, set time, set alarms, set alerts, etc.)
- What band types you want to detect
- How you want the display to look

#### R9w Basics Setup

Press **MENU**, then **VOL+** to scroll through the menu to set up the following menu items:

- **Mode** (Default = Highway). Lets you select different band sensitivities. (Highway = Full Sensitivity; City = X, K sensitivity reduced with Ka at full sensitivity; Auto = City mode is automatically changed to Highway or City depending on the Auto City Speed setting (10 - 60 mph, Default = 40 mph), driving speed when you set the City mode to Auto; and Advanced = Adjust sensitivity from 100% to 30% in 10% increments)
- **GPS** (Default = On). Determines your geographic location in relation to established speed and red-light cameras. When GPS is on, other GPS-related menus display throughout the menu system.
- **Speed Camera** (Default = On). Speed camera icon displays on OLED screen and an alarm sounds when you are within range of a speed camera.
- **Red Light Camera Alarm** (Default = On). Red light camera icon displays on OLED screen and alarm sounds when you are within range of a red light camera.
- **Voice** (Default = On). Turn on voice to sound out menu items, alerts, alarms, etc.
- **Auto Mute** (Default = On). Turn on Auto Mute to automatically reduce the alarm volume to the level set in the Alarm Mute Volume menu (Auto Mute Volume = 0 - 7).
- **GMT**. Sets time according to Greenwich Mean Time. Most common time zone settings for North America are:
  - GMT-05:00 - Eastern Standard
  - GMT-06:00 - Central Standard
  - GMT-07:00 - Mountain Standard
  - GMT-08:00 - Pacific Standard
  - GMT-09:00 - Yukon Standard
  - GMT-10:00 - Alaska-Hawaii Standard
- **DST** (Default = Off). Turn Daylight Saving Time on or off.

#### R9w Band Type Setup

Press **MENU**, then **VOL+** to scroll through the menu to set up the following menu items:

- **Front Radar** (Default = On). Turn off to ignore incoming frequencies.
- **Front X Band** (Default = Off). Keep off to have the front detector ignore X band frequencies.
- **Front K Band** (Default = On). Turn off to have the front detector ignore K band frequencies.
- **Front Ka Band** (Default = On). Turn off to have the front detector ignore Ka band frequencies.
- **Rear Radar** (Default = On). Turn off to ignore incoming frequencies.
- **Rear X Band** (Default = Off). Keep off to have the rear detector ignore X band frequencies.
- **Rear K Band** (Default = On). Turn off to have the rear detector ignore K band frequencies.
- **Rear Ka Band** (Default = On). Turn off to have the rear detector ignore Ka band frequencies.
- **K Narrow/Wide/Extended** (Default = K Wide). K Narrow scans for K band radar guns used in the US only and reduces false alarms. K Wide scans for normal K band radar guns operating at 24.050 – 24.250GHz. Extended detects signals below 24.050 (23.900 – 24.250GHz).

#### R9w Display Setup

You can set up the OLED displays through the Menu system to show specific types of information. For example, through **MENU/Left Display**, you can choose between 5 options for the left side display if GPS is on. This illustration shows those options as well as icons that display as you approach recognized elements such as a red-light or speed camera.

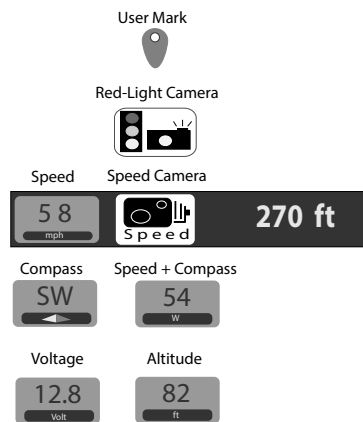

If GPS = ON, the OLED's left display area shows the display selected in the menus.

If GPS = Off, the OLED's left display area shows Volt regardless of user settings.

Press MENU, then VOL+ to scroll through the menu to set up the following menu items:

- **Background Color** (Default = Red). Press MENU to scroll through and select a background color for both the keypad and the display.
- **Backlight** (Default = On). Turn the keypad backlight on or off. The backlight will be the same as Background Color.
- **Left Display** (Default = Speed). Sets what appears on the left side of the OLED screen.
- **Speed Unit** (Default = mph). Select which measurement of speed displays (mph or km/h).
- **Display** (Default = Mode). Select what appears on the main display area.
- **Arrow Color** (Default Front = Red; Default Rear = Blue). Select a color for the front and rear arrows that show the direction of the incoming radar signal.

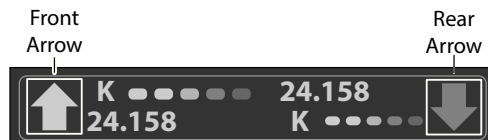

- **Band Color** [Default = Signal (band color same as signal strength level color)]. Set the color for each front and rear radar band.

Band color matches the signal strength level color as below if the "Signal" option is selected.

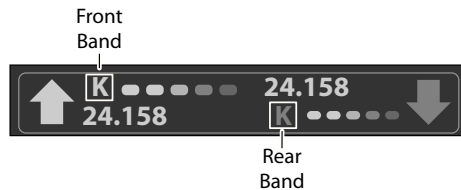

## ESTABLISHING CONNECTIVITY

**NOTE:** Refer to the R9w Owner's Manual for detailed procedures.

### BLUETOOTH

1. Put your device in pairing mode.
2. In the R9w menus, be sure BT/WiFi is set to On and then select BT Pairing. *Pairing R9w* displays.
3. R9w displays on your device as an available device for pairing. Select it to begin pairing.
4. *Success* displays when Pairing is complete. When R9w is connected to the device through Bluetooth Pairing, *B* displays on the screen.

### WIFI

Having a WiFi connection between your radar detector and the router lets you easily download firmware and database updates. Use the Uniden R/TACH app (available in the Google Play or the iPhone App stores) to create this connection.

**NOTE:** This product's WiFi operates at 2.4GHz. If your router/modem automatically switches between speeds, no further action is necessary. If your router does not switch automatically, contact your WiFi provider for more information on how to set your router to 2.4GHz.

1. Download the Uniden R/TACH radar app from the Google Play or the Apple app store.
2. Run the app and pair it with the R9w. The app connects with it.
3. After connecting, select the WiFi Settings tab in the app. Enter your SSID and password.
4. Click the Connect tab on the app to connect to the WiFi router you set up in the previous step.
5. Once connected, you will automatically connect to that WiFi router if nearby.
6. Disconnect the R9w and reconnect it to your vehicle. The WiFi icon displays on the R9w screen.

## UPDATING THE FIRMWARE/DATABASE

**NOTE:** The following procedures assume that the R9w is connected to WiFi. Be sure the WiFi connection icon displays.

The Update Available down arrow icon displays if updated software and/or an updated GPS database is available on the Uniden website ([uniden.com](http://uniden.com)).



1. Select *WiFi Update* in the menus; *WiFi Update* displays.
2. Press MENU to display 3 options:
  - Full - Update all interfaces (Host, Front/Rear Radar, GPS, Sound DB, GPS DB, BT/ WiFi, Keypad, Laser, and Display)
  - DB - Only update the GPS database
  - Exit - Leave the update feature and return to the main display screen
3. Press VOL+ to move right or VOL- to move left. Press MENU to select an option.
4. Download begins. *Update Completed!* displays when download is complete.



## THREE-YEAR LIMITED WARRANTY

Keep your receipt! Proof of purchase from an authorized Uniden dealer, reseller or installer is required for warranty service.

### WARRANTOR: UNIDEN AMERICA CORP. ("UNIDEN").

**LIMITED WARRANTY:** Uniden warrants, for three years, to the original retail owner, this Uniden Product to be free from defects in materials and craftsmanship, subject to the limitations and/or exclusions set forth herein. This warranty shall terminate 36 months after the date of the original retail sale.

**LIMITATIONS AND EXCLUSIONS:** This warranty applies only to purchases made from an authorized Uniden dealer, reseller or installer by the original retail purchaser of to the recipient of the product as a gift from the original retail purchaser. Proof of purchase or gift receipt is required. This warranty is invalid and/or shall be void if the Product has been (A) damaged or not maintained as reasonable or necessary, (B) modified, altered, or used as part of any conversion kits, subassemblies, or any configurations not sold by Uniden, (C) improperly installed, (D) serviced or repaired for a defect of malfunction covered by this warranty by someone other than an authorized Uniden service center, (E) used in conjunction with equipment or parts or as part of any system not manufactured by Uniden, or (F) installed or programmed by anyone other than as detailed by the Installation Guide or Owner's Manual included for this Product. The Warranty does not apply to Products purchased from non-authorized dealers, resellers, or installers, including, but not limited to, online auction websites or other similar platforms.

**STATEMENT OF REMEDY:** In the event that the product does not conform to this warranty at any time while this warranty is in effect, warrantor will repair the defect without charge for parts, service, or any other cost (except shipping and handling, if applicable) incurred by warrantor or its representatives in connection with the performance of this warranty.

**THE LIMITED WARRANTY SET FORTH ABOVE IS THE SOLE AND ENTIRE WARRANTY PERTAINING TO THE PRODUCT AND IS IN LIEU OF AND EXCLUDES ALL OTHER WARRANTIES OF ANY NATURE WHATSOEVER, WHETHER EXPRESS, IMPLIED OR ARISING BY OPERATION OF LAW, INCLUDING, BUT NOT LIMITED TO, ANY IMPLIED WARRANTIES OF MERCHANTABILITY OR FITNESS FOR A PARTICULAR PURPOSE. THIS WARRANTY DOES NOT COVER OR PROVIDE FOR THE REIMBURSEMENT OR PAYMENT OF INCIDENTAL OR CONSEQUENTIAL DAMAGES.** Some states do not allow this exclusion or limitation of incidental or consequential damages so the above limitation or exclusion may not apply to you.

**LEGAL REMEDIES:** This warranty gives you specific legal rights, and you may also have other rights which vary from state to state. This warranty is void outside the United States of America.

**PROCEDURE FOR OBTAINING PERFORMANCE OF WARRANTY:** If, after following the instructions in the Installation Guide and Owner's Manual, you are certain that the Product is defective, please contact (i) the authorized Uniden installer who installed your product, or (ii) Customer Support at [uniden.com](http://uniden.com). Please be ready to provide evidence of original gift receipt and information describing the defect you believe exists.

Uniden America Corporation  
301 International Parkway, Suite 460  
Flower Mound, Texas 75022

POP Mode is a trademark of MPH Industries, Inc.

Spectre 1 and Spectre IV are trademarks of Stealth Micro Systems Pty. Ltd.