

UDR744 HD

QUICK START GUIDE

Use this Quick Start Guide to install your cameras and connect your smartphone or other device for remote viewing.

For more detailed information, refer to the online user manual at:

www.uniden.com

IN THE BOX

Camera (2)	Antenna (2)	Monitor (1)	5V AC Power Adapter for Monitor (1)	8GB SD Card
9V AC Power Adapter for Camera (2)	Ethernet Cable (1)	Screw Pack (2)	UDR744 HD Quick Start Guide (1)	

SET UP CAMERAS AND MONITOR

1. Attach power adapters to the cameras. Plug into power.
2. Attach power adapter to the monitor. Plug into power.
3. Turn on monitor. You should see both cameras.
4. Unplug cameras and take them to where they are to be set up. Plug in and verify that they are still visible to the monitor. If not, relocate them.

INSTALL THE UDR744 HD CAMERAS

1. Hold the base of the camera stand where you want to mount it and mark the location of the screw holes.
2. Use the included screws and anchors to attach the base to the wall or ceiling. You can also screw the base into a flat surface such as a tabletop if needed.
3. Tug gently on the base to make sure it is securely in place.



SET UP REMOTE VIEWING

1. Connect monitor to your router using ethernet cable.
2. Download the free Uniden U Guard™ app from Google Play or Apple iTunes. Start app.
3. Tap *Click here to add device*.

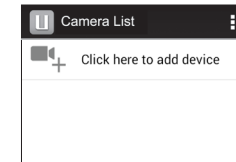

4. Scan the QR code on the back of the monitor to get the UID code.
5. Tap *Name* to rename the camera and enter the default password (000000). Tap *OK*.

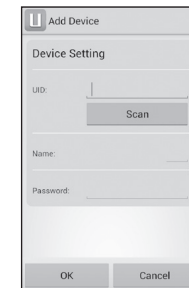

6. The camera now displays on the *Camera List*. Tap the camera listing to view live video.

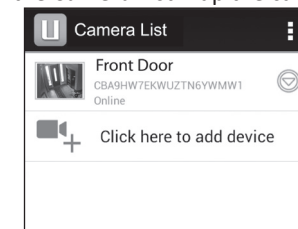

For complete operation instructions, refer to the online user manual at www.uniden.com.